

CAMLOCK COUPLING

General dimensions :

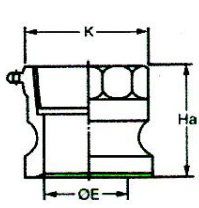

TYPE A

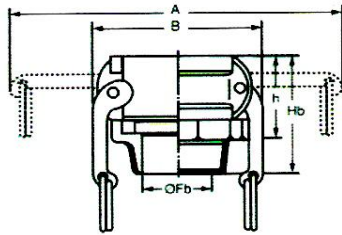

TYPE B

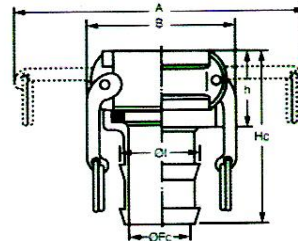

TYPE C

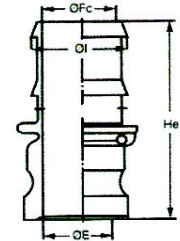

TYPE E

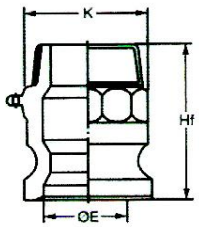

TYPE F

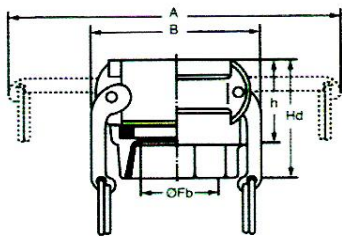

TYPE D

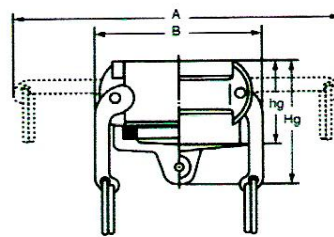

TYPE G (DC)

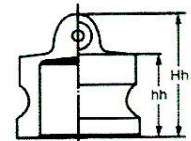

TYPE H (DP)

SIZE		A	B	E	Fb	Fc	I	K	Ha	Hb	Hc	Hd	He	Hf	Hg	Hh	h	hg	hh
mm	mcl																		
15	1/2"	68	50	14	16	-	-	32	41	52	-	-	-	-	-	-	-	-	-
20	3/4"	116	50	19	22	14	21	38	41	52	84	51	92	55	45	40	33	32	27
25	1"	125	60	24	26	20	27	41	49	62	98	62	106	65	56	48	40	41	33
32	1 1/4"	177	80	29	35	25	34	51	54	67	103	71	113	76	67	58	46	51	42
40	1 1/2"	188	89	37	38	32	41	57	55	70	106	71	117	79	69	61	48	51	43
50	2"	197	97	46	50	45	53	71	64	79	127	75	130	86	75	69	54	57	49
65	2 1/2"	210	110	55	61	57	67	84	70	89	137	86	146	97	80	71	55	60	51
80	3"	248	135	73	75	67	79	100	70	91	160	89	168	100	80	74	60	60	51
100	4"	280	165	98	94	89	105	129	80	102	170	95	178	114	82	79	62	62	54
125	5"	306	190	122	117	114	134	168	79	105	189	100	200	117	85	79	65	65	54
150	6"	595	254	148	142	142	157	192	86	115	214	115	220	129	90	85	70	70	60

Camlock Coupling is interchangeable with all couplings complying with MIL C27487 specification.

Cam arm quick coupler is simple and efficient way to make a quick tight, leak free connection between two parts of process line. The metals are recommended for a max pressure of 250psi for 3/4" to 2", 150psi for 2 1/2", 125psi for 3", 100psi for 4" and 75psi for 5" & 6". P/P 125psi for 3/4" to 1 1/2", 100psi for 2" to 3". Material range : SS316, Brass, Bronze, Aluminum sand casting, ductile and P/P.

Cam Arms, Ring & Pin



Forged bronzed
S/S Investment
Plated R. and P.
S/S R. and P.

GASKET:



NBR (Standard)
EPDM
TEFLON
VITON
SILICONE